

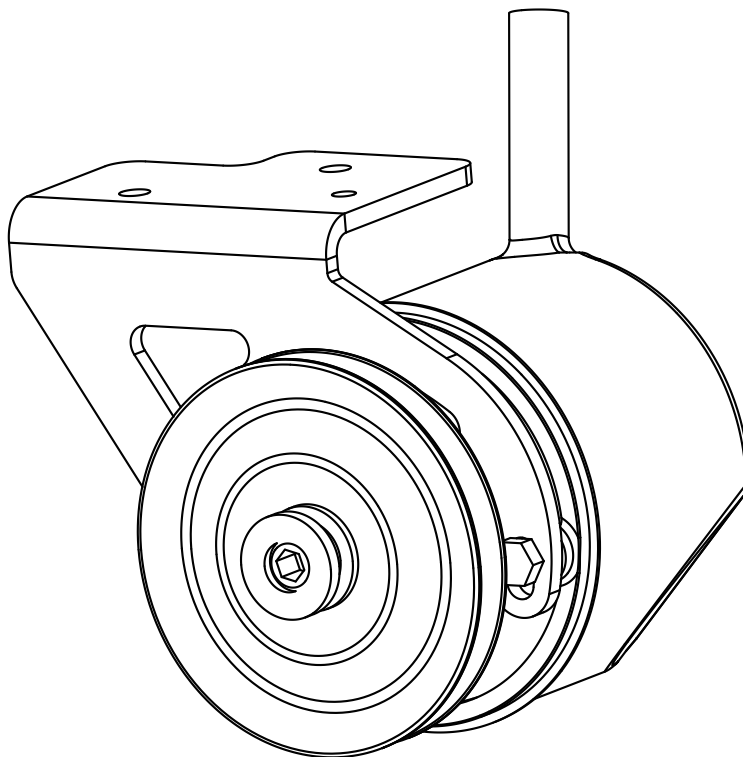

1965-76 Ford FE

Power Steering Add-on Bracket Kit (137159)



18865 Goll St. San Antonio, TX 78266
Phone: 800-862-6658
Sales: sales@vintageair.com
Tech Support: tech@vintageair.com
www.vintageair.com



www.vintageair.com

Table of Contents

Cover.....	1
Table of Contents.....	2
Packing List/Parts Disclaimer.....	3
Bracket Installation.....	4
Bracket Installation (Cont.).....	5
Bracket Installation (Final).....	6
Belt Routing.....	7
Compressor Warnings.....	8
Packing List.....	9

Additional Info: Please Read Before Beginning

- This kit was designed for 1965-76 FE engines such as the 1965 Galaxie 390.
- This kit may be compatible with earlier or later applications but will be dependent on pulleys and accessories.
- This kit was designed for use with a 2-groove water pump pulley and 2-3 groove crank pulley.
- This kit requires compressor bracket kit 137154, Ford Power Steering pulley such as 7AA, and Ford HBA style power steering pumps.
- **This bracket is designed to be mounted fixed to the compressor bracket. The power steering pump tensions when the compressor is tensioned.**
- This bracket is compatible with 1965-77 Ford/Thompson pumps as well as 1978+ Ford Pumps



www.vintageair.com

Packing List: Bracket Kit (137159)

No.	Qty.	Part No.	Description
1.	1	137158	Bracket, Power Steering Add-on
2.	1	191159	Hardware Kit

**** Before beginning installation, open all packages and check contents of shipment.
Please report any shortages directly to Vintage Air within 15 days. After 15 days,
Vintage Air will not be responsible for missing or damaged items.**

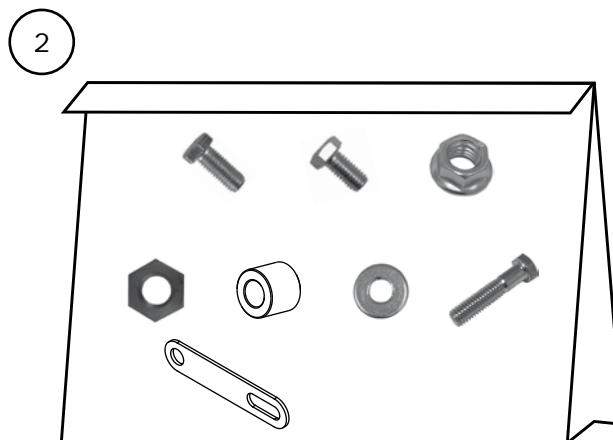
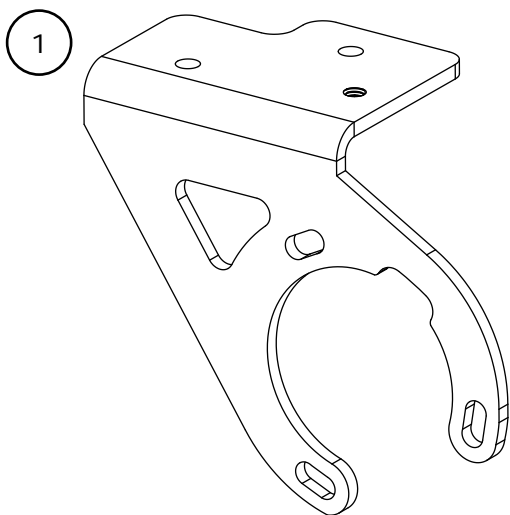

**NOTE: Images may not depict actual parts and quantities.
Refer to packing list for actual parts and quantities.**

NOTE: Before tightening bolts, assemble all brackets loosely to engine. This will ensure proper alignment of all brackets.

www.vintageair.com

Bracket Installation

1. Disconnect the battery.
2. Release the tension from the compressor bracket.
3. If using the larger style Ford power steering pump, remove the lower bolt from the compressor bracket for later installation of the rear support bracket (See Figure 1, below).
4. Locate the power steering add-on bracket (See Figure 2, below).
5. Place the Ford power steering pump behind the bracket with the pulley removed (See Figure 2, below).

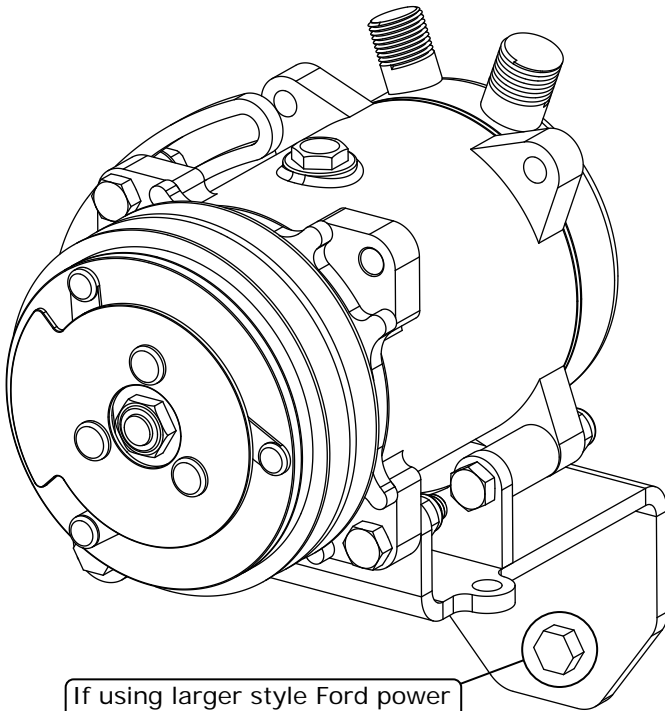

If using larger style Ford power steering pump, remove lower bolt from compressor bracket

Figure 1

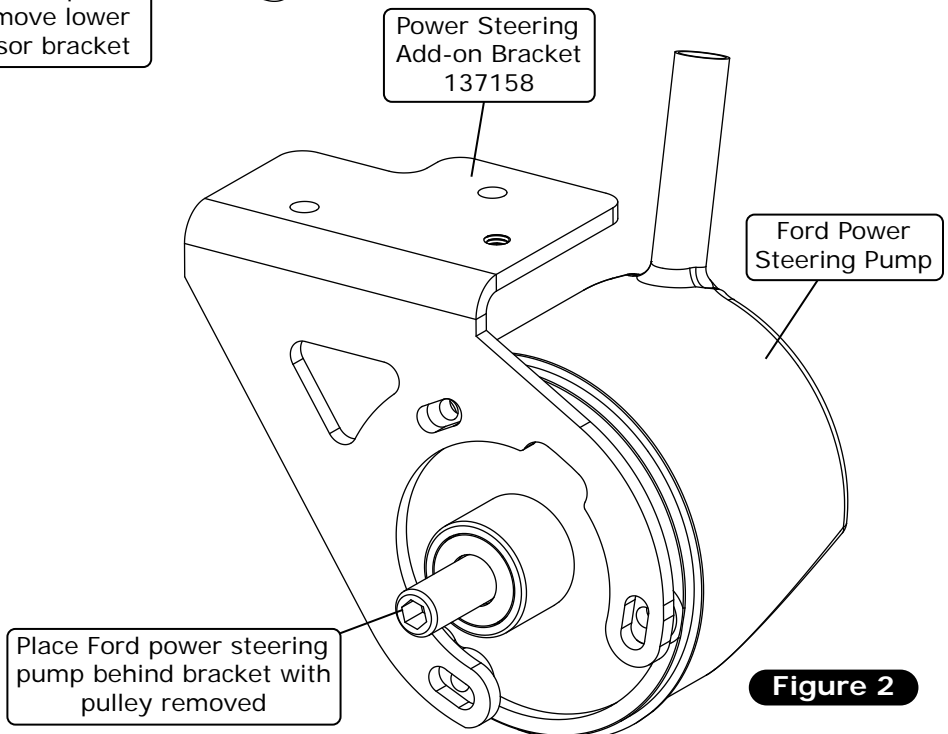

Figure 2

Bracket Installation (Cont.)

6. Secure the pump to bracket using (3) 3/8-16 x 1" hex bolts (See Figure 3, below).
7. Install the pulley onto the pump (See Figure 4, below).
8. Lift the power steering assembly under the compressor bracket assembly (See Figure 5, below).
9. The power steering assembly can be held in place using a 3/8-16 x 3/4" hex bolt threaded into the boss of the power steering bracket (See Figure 5, below).
10. Secure the bracket using (2) 3/8-16 x 1" hex bolts and (2) 3/8-16 serrated flange hex nuts (See Figure 5, below).
11. Tighten all (3) bolts at this time.

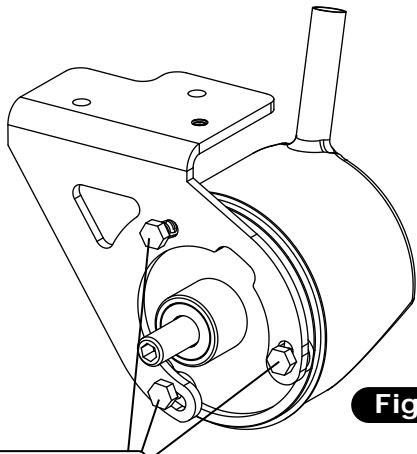

Figure 3

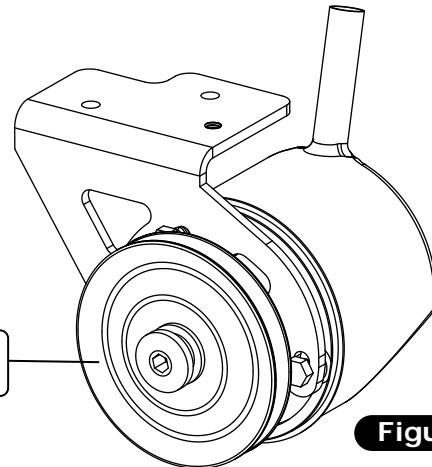

Figure 4

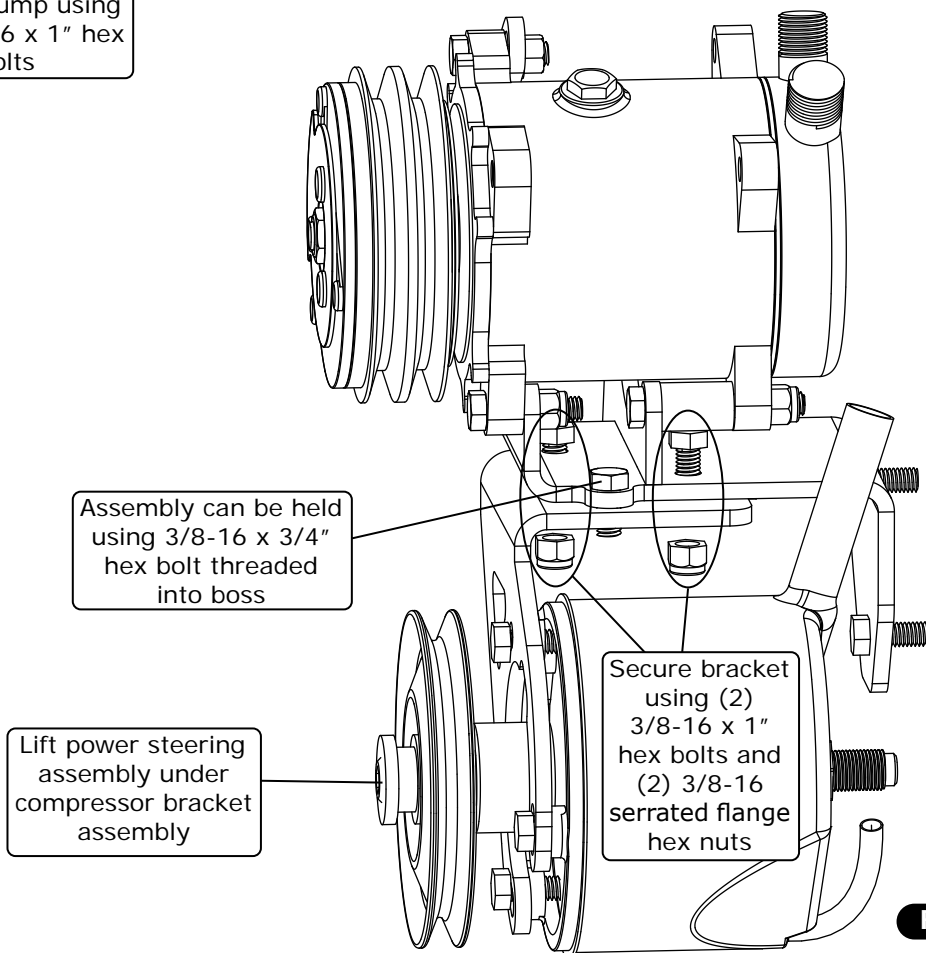

Figure 5

Bracket Installation (Final)

12. If using the larger style Ford power steering pump, the included rear bracket may be installed to support the rear of the pump.
13. Secure the rear power steering bracket onto the pump using a 5/8-18 jam nut (See Figure 6, below).
14. Install a 3/8-16 x 1 3/4" hex bolt, 5/16" flat washer and a .625" length spacer onto the bracket and into the head (See Figure 6, below).
15. Connect the power steering pressure and return lines per OEM requirements.
16. Install the belt and tension using the compressor tensioning tool (See Figure 7, below).

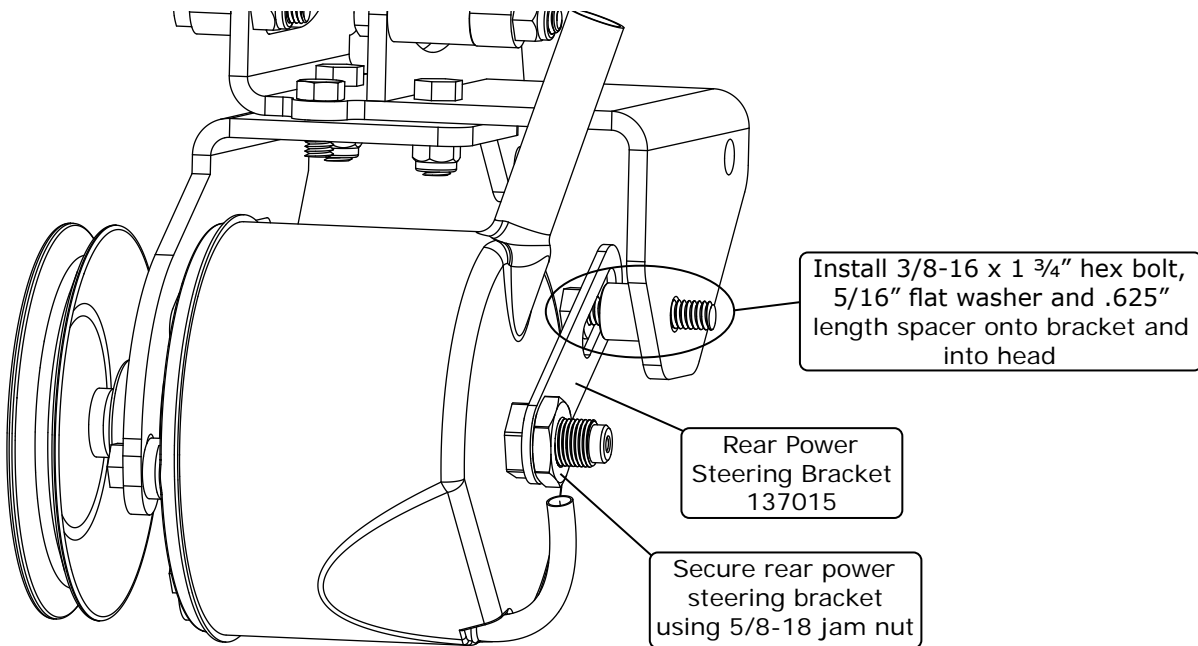

Figure 6

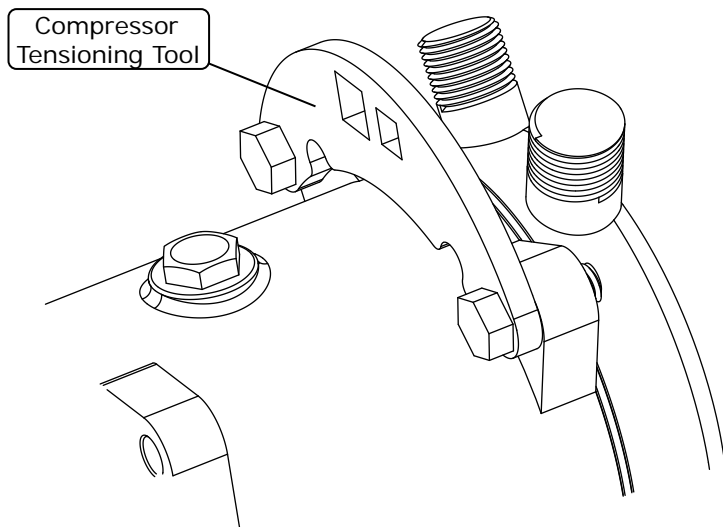
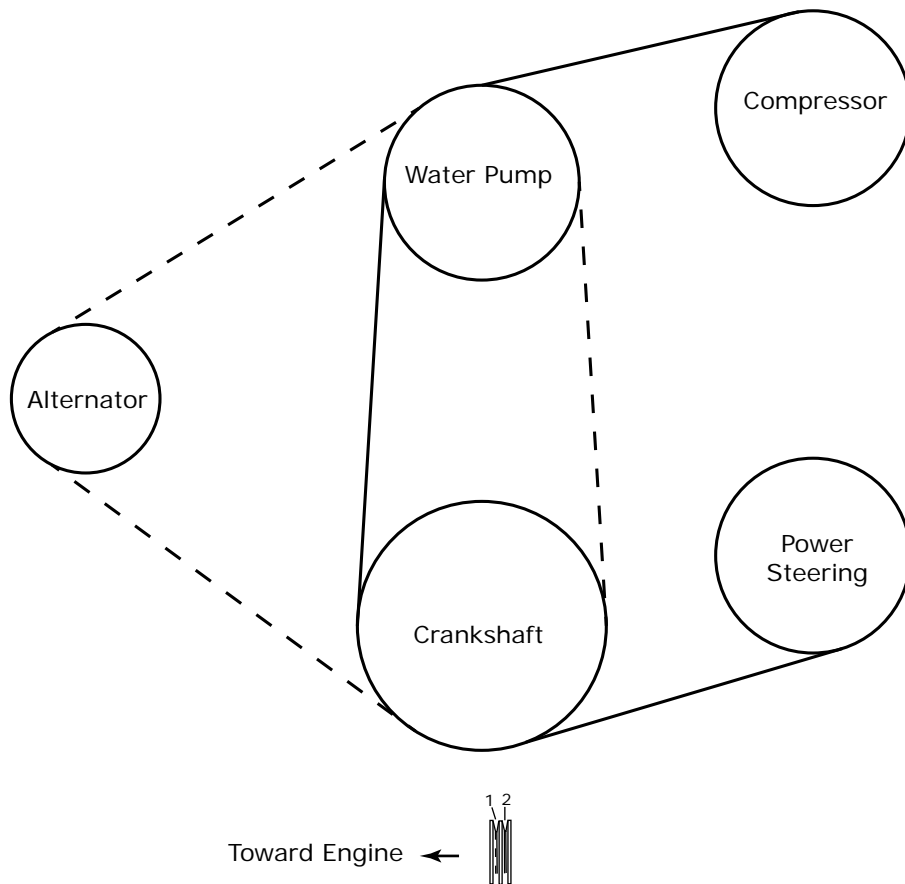

Figure 7

Belt Routing

1. Route belt as shown below. Vintage Air recommends using only Dayco, Gates or Goodyear brand reinforced V-belts with this compressor bracket kit.



Crankshaft Pulley Grooves:

1. Crankshaft, Water Pump & Alternator
2. Crankshaft, Water Pump, Compressor, Power Steering (Optional)

Important Compressor Information

Sanden 508 Style Compressors

NOTE: Failure to follow these procedures may void all warranties.

- Do not connect compressor clutch wire until system is being charged with refrigerant. Since an A/C system relies on refrigerant to circulate lubricant, running the compressor without refrigerant may destroy the compressor and void the warranty.
- Proper compressor orientation is important. Sanden compressors may be rotated from vertical (oil fill plug at top) up to 90° in either direction (See illustration, below).

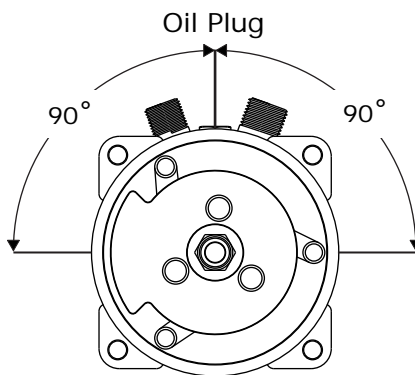

Sanden 7B10 Style Compressors

NOTE: Failure to follow these procedures may void all warranties.

- Do not connect compressor clutch wire until system is being charged with refrigerant. Since an A/C system relies on refrigerant to circulate lubricant, running the compressor without refrigerant may destroy the compressor and void the warranty.
- These compressors do not have an oil fill plug. Please reference the block fitting mount face for clocking range (See illustration, below).

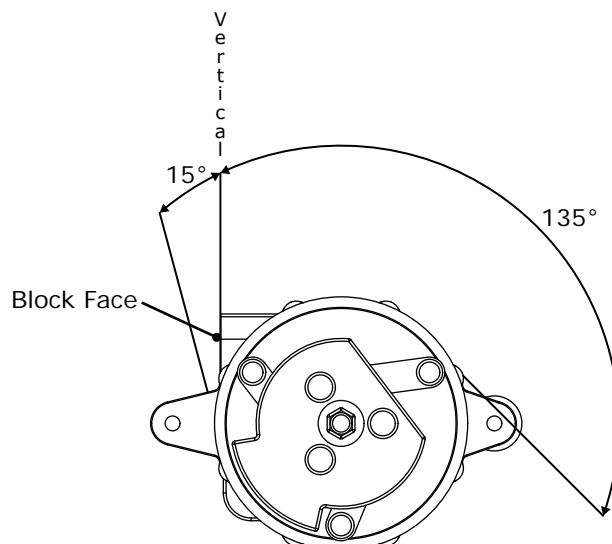



www.vintageair.com

Packing List: Bracket Kit (137159)

No.	Qty.	Part No.	Description
1.	1	137158	Bracket, Power Steering Add-on
2.	1	191159	Hardware Kit

Checked By: _____
Packed By: _____
Date: _____

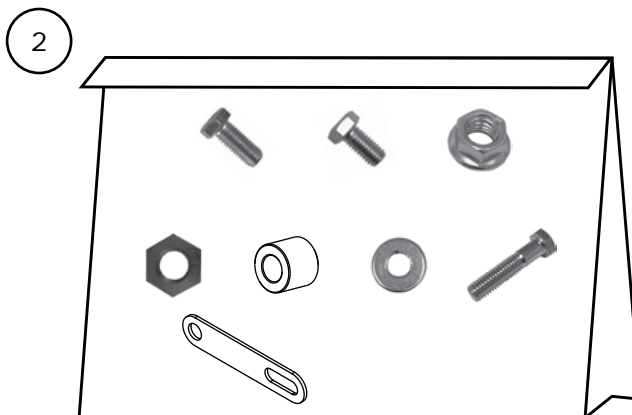
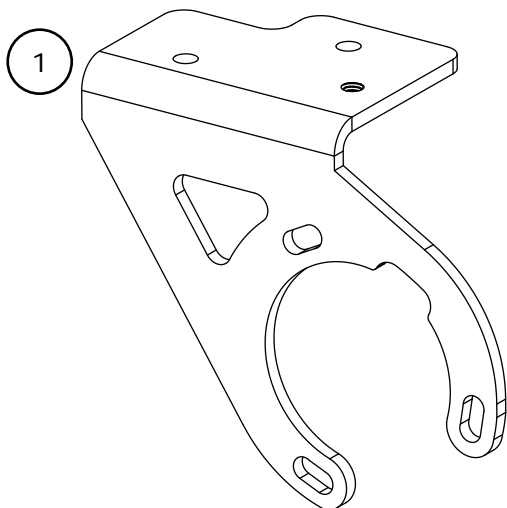

NOTE: Images may not depict actual parts and quantities.
Refer to packing list for actual parts and quantities.



www.vintageair.com

Packing List:
1965-76 Ford FE
Add-on Power Steering Bracket
Hardware Kit (191159)

No.	Qty.	Part No.	Description
1.	1	18358-VUB	Bolt, 3/8-16 x 3/4", Hex
2.	5	18359-VUB	Bolt, 3/8-16 x 1", Hex
3.	2	181560	Nut, 3/8-16, Serrated Flange Hex
4.	1	186077	Nut, 5/8-18, Jam
5.	1	18153-VUB	Spacer, .750" O.D. x .406" I.D. x .625" Length
6.	1	18611-VUB	Washer, 5/16", Flat
7.	1	18362-VUB	Bolt, 3/8-16 x 1 3/4", Hex
8.	1	137015	Bracket, Power Steering Rear

Checked By: _____
Packed By: _____
Date: _____

1



2



3



4

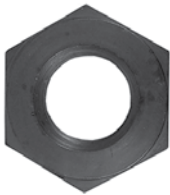

5

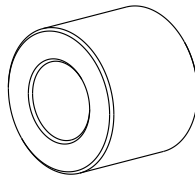

6

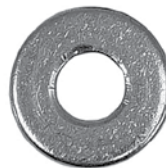

7



8

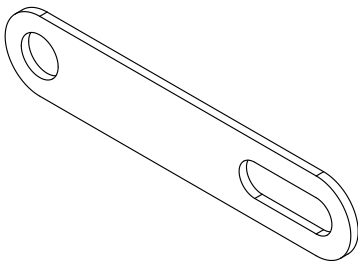

NOTE: Images may not depict actual parts and quantities.
Refer to packing list for actual parts and quantities.